

High Purity Ball Valves M3HP True Bore (1/2"–2" / DN 10-50 DIN ASME BPE)

DESCRIPTION

M3H three pieces body ball valves are isolating valves designed for use on clean steam, condensate and other gases and liquids used in high purity and aseptic processes. The valve is not designed as a control valve and should be used only as an isolating valve, fully open or fully closed. The product was mainly designed for the pharmaceutical, biotech, semiconductor, cosmetics, fine chemical, food and beverage industries.

MAIN FEATURES

1. True bore floating ball design A351 CF3M body ends with ferrite content of less than 3% and low sulphur between 0.005 and 0.017%
2. Can be serviced without removal from pipeline
3. Bidirectional
4. Anti blow out proof stem ISO 5211 mounting

STANDARD SURFACE FINISH

Internal wetted parts: ≤ 0,51 micron Ra –SF1

External : ≤ 0,76 micron Ra –SF3

Ultrasonic cleaning



CE MARKING (PED - European Directive)		
PN 100	PN 63	Category
1/2" to 1"	/	SEP
/	1 1/2" - 2"	1 (CE Marked)

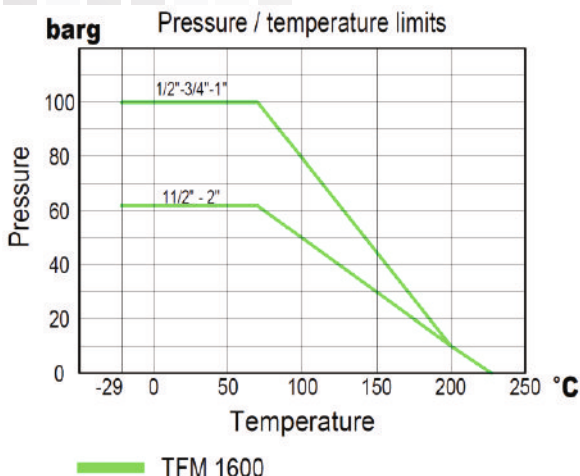

OPTIONS:

Antistatic device
Different sealing materials
Degreased for oxygen use

USE:

Clean steam, gases and liquids compatible with the construction.

AVAILABLE MODELS:

M3H – Complete bar stock construction

SIZES:

DN1/2" to DN 2"

CONNECTIONS:

According to ASME BPE
TC – Sanitary clamps
ETO – Extended tube orbital welding
TC / ETO Combination

PACKAGING:

Assembling and packaging in a clean room certified according to ISO 14644 1. The product is end capped and vacuum sealed with recyclable plastic film to avoid contamination.

INSTALLATION:

See IMI, installation and maintenance instructions.

High Purity Ball Valves M3HP True Bore (1/2"–2" / DN 10-50 DIN ASME BPE)

MATERIALS

POS. Nº	DESIGNATION	MATERIAL
1	Valve body	AISI 316L / 1.4404
2	TC end connection	AISI 316L / 1.4404
3	Tube weld end connection	AISI 316L / 1.4404
4	Flange	AISI 316L / 1.4404
5	Stem	AISI 316L / 1.4404
6	* Valve ball	AISI 316L / 1.4404
7	* Standard seat	1600
8	* Cavity filler seat	TFM 1600
9	* Body seal	PTFE
10	* Stem seals	TFM 1600
11	* Spacer	AISI 316 / 1.4401
12	Handle	AISI 304 / 1.4301
13	Handle end	Vinyl
14	Handle end (optional)	AISI 316L / 1.4404
15	* Spring washers	AISI 304 / 1.4301
16	Compression nut	AISI 304 / 1.4301
17	* Lock washer	AISI 304 / 1.4301
18	Fixing bolt	AISI 304 / 1.4301
19	Stop pin	AISI 304 / 1.4301
20	Handle stopper	AISI 304 / 1.4301
21	Washer	AISI 304 / 1.4301
22	Fixing screw	AISI 304 / 1.4301
23	** Antistatic device	AISI 316 / 1.4401
24	O-ring	Viton

* Available spare parts. ** On request

*** Loose flange only applied on the 360° rotation version optional

Remarks: FDA/USP Class VI seals certificate on request

All valves have a serial number. In case of non-standard

valves this number must be supplied if spare parts are ordered

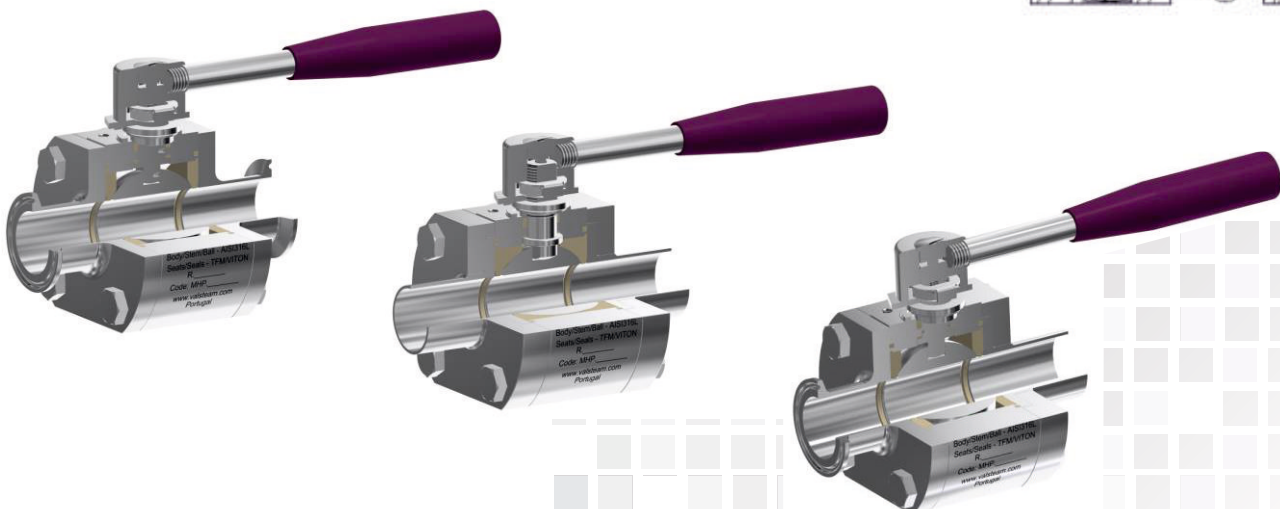
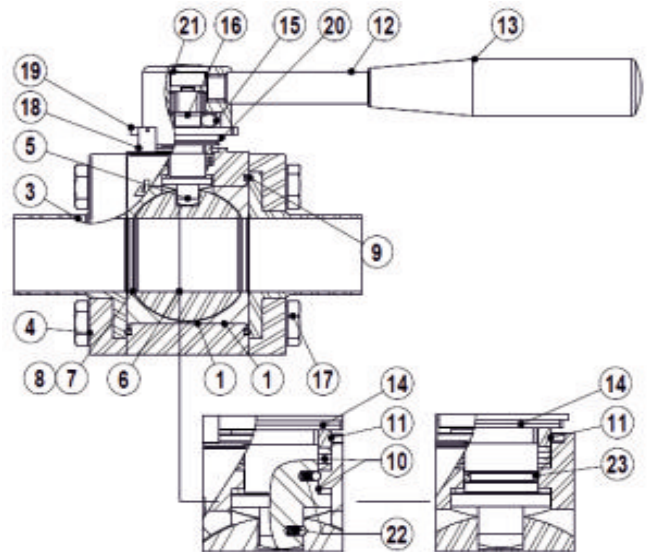
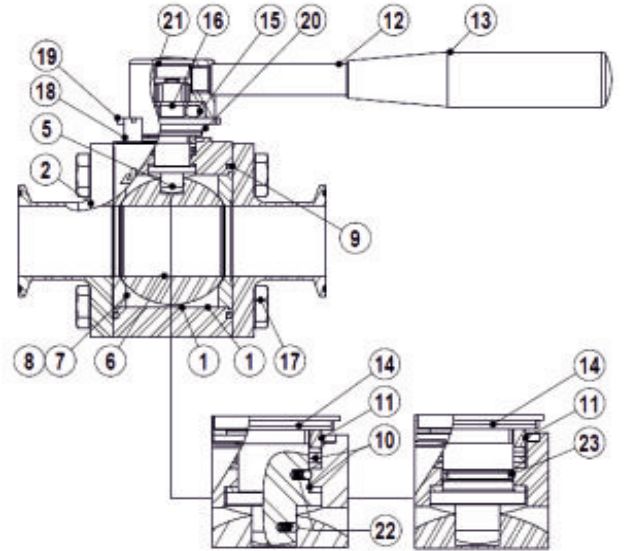

High Purity Ball Valves M3HP True Bore (1/2"–2" / DN 10-50 DIN ASME BPE)

DIMENSIONS (mm) ASME BPE

SIZE	A1	A2	A3	A3.1	A3.2	B	C	D	E	ØF	ØG	ØH	I	BALL PORT	ISO 5211	WGT. (kg)
1/2"	88,9	101,6	95,5	44	51,5	59	22	49	130	25	12,7	9,4	25	9,4	F03 *	0,9
3/4"	101,6	114,3	108	51	57	64	24,5	53	130	25	19,05	15,75	27	15,8	F03 *	1,4
1"	114,3	127	120,5	57	63,5	79	31	68	165	50,5	25,4	22,1	27	22,1	F04	2,3
1 1/2"	139,7	152,4	146,5	70	76,5	109	44	86	200	50,5	38,1	34,8	27	34,8	F05	5,3
2"	165,1	177,8	171,5	82,5	89	134	53	97	200	64	50,8	47,5	28	47,5	F05	8,5

* Flange adapter is required, against extra price. See IS M3H.25 E Options and extras.

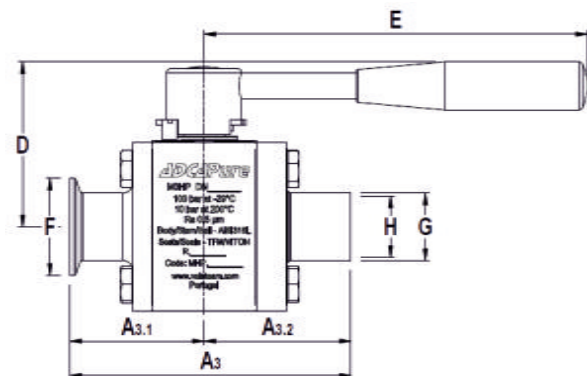
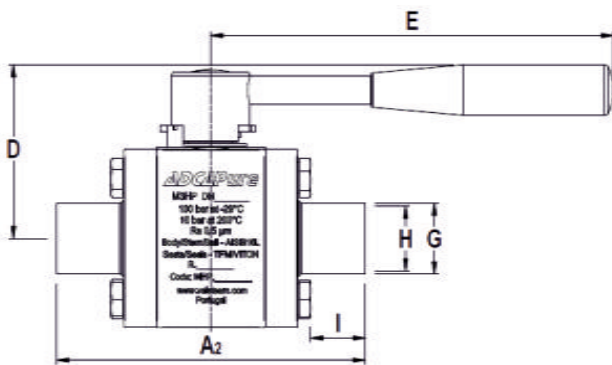
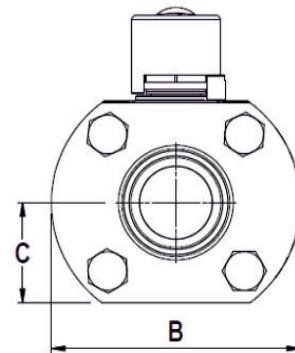
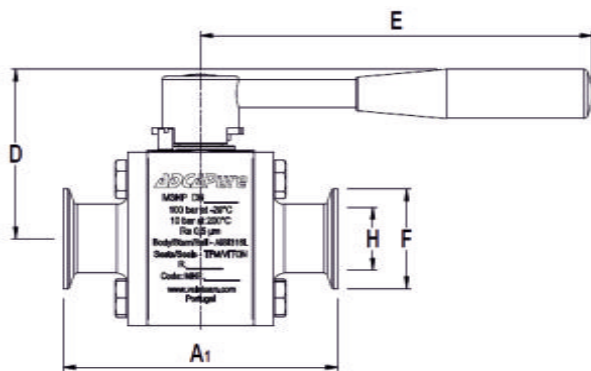

Tube weld easy and quick installation - standard

