

Hygienic Ball Valves M3H True Bore (2½" to 4" ASME BPE | DN 65 - 100 DIN)

DESCRIPTION

M3HP three piece body ball valves are isolating valves designed for use with clean steam, condensate and other gases and liquids used in high purity and aseptic processes. The valve is not designed as a control valve and should only be used as an isolating valve, fully open or fully closed. The product is mainly designed for the pharmaceutical, biotech, semiconductor, cosmetics, fine chemical, food and beverage industries.

MAIN FEATURES

1. True bore floating ball design
 2. A351 CF3M body and ends with ferrite content of less than
 3. 2% and low sulphur between 0,005 and 0,017%
 4. Can be serviced without removal from pipeline
 5. Bidirectional
- Anti blow out proof stem
ISO 5211 mounting

STANDARD SURFACE FINISH

Internal wetted parts: ≤ 0,51 micron Ra . SF1.

External : ≤ 0,76 micron Ra . SF3.

Ultrasonic cleaning



CE MARKING (PED – European Directive)

PN40	Category
2½" to 4"	1 (CE marked)
DN 65 to DN 100	1 (CE Marked)

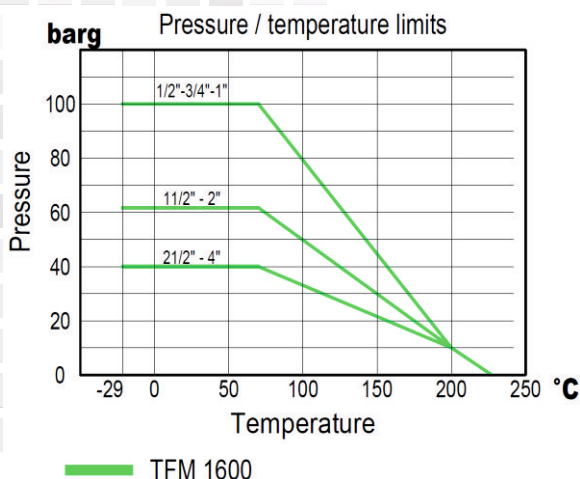

OPTIONS:

Antistatic device.
Different sealing materials.
Degreased for oxygen use.
Tube weld with loose body flanges (360° rotation after installation).
Cavity filler.

USE:

Clean steam, gases and liquids compatible with the construction.

AVAILABLE MODELS:

M3H—Investment casting
SIZES: 2½" to 4" | DN 65 - 100 DIN

CONNECTIONS:

According to ASME BPE.
TC – Sanitary clamps.
ETO – Extended tube orbital welding.
TC / ETO – Combination.

PACKAGING:

Assembling and packaging in a clean room certified according to ISO 14644-1. The product is end capped and sealed with recyclable thermo-shrinkable plastic film, to avoid contamination.

INSTALLATION:

See IMI, installation and maintenance instructions.

Hygienic Ball Valves M3H True Bore (2½" to 4" ASME BPE | DN 65 - 100 DIN)

MATERIALS

POS. Nº	DESIGNATION	MATERIAL
1	Valve body	CF3M / 1.4409
2	TC end connection	CF3M / 1.4409
3	Tube weld end connection	CF3M / 1.4409 (integral)
3	Tube weld end connection	AISI 316L / 1.4404 (360º rotation)
4	*** Flange	AISI 316L / 1.4404
5	Stem	AISI 316L / 1.4404
6	* Valve ball	AISI 316L / 1.4404
7	* Standard seat	TFM 1600
8	* Cavity filler seat	TFM 1600
9	Body ring	AISI 316L / 1.4404
10	* Body seal	PTFE
11	* Stem seals	TFM 1600
12	* Spacer	AISI 316 / 1.4401
13	Handle	AISI 304 / 1.4301
14	Handle end	Vinyl
15	* Spring washers	AISI 304 / 1.4301
16	Compression nut	AISI 304 / 1.4301
17	* Lock washer	AISI 304 / 1.4301
18	Fixing bolt	AISI 304 / 1.4301
19	Stop pin	AISI 304 / 1.4301
20	Handle stopper	AISI 304 / 1.4301
21	** Antistatic device	AISI 316 / 1.4401
22	O-ring	Viton

* Available spare parts. ** On request.
FDA / USP Class VI seals certificate on request.
All valves have a serial number. In case of non standard valves this number must be supplied if spare parts are ordered.

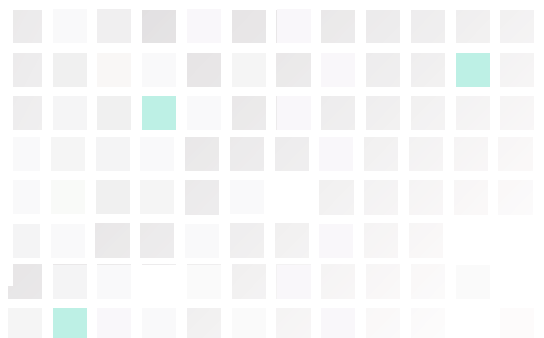
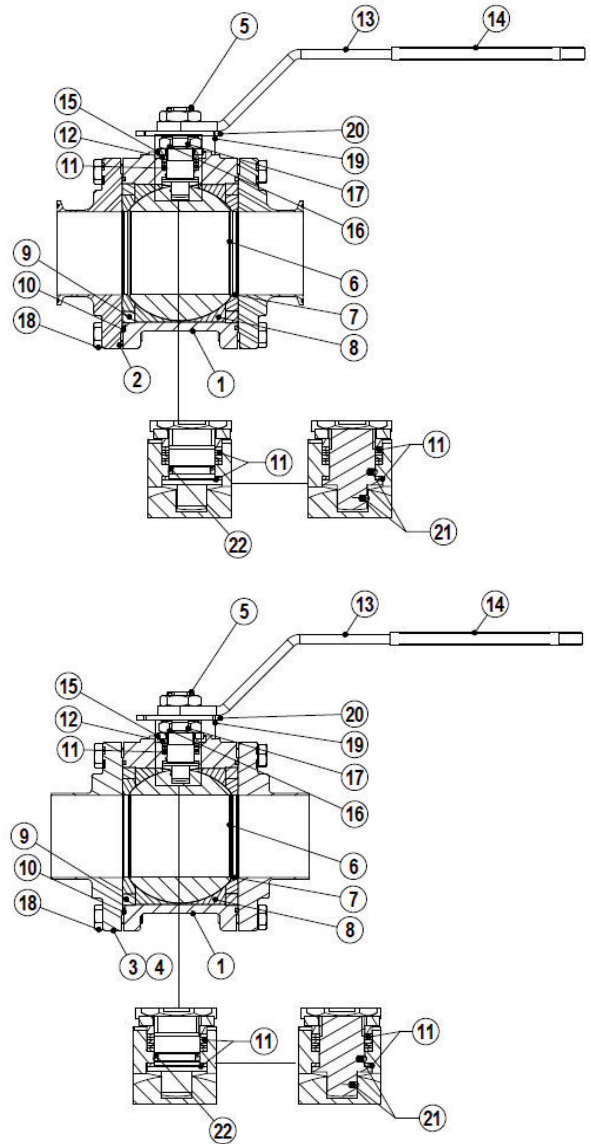

Hygienic Ball Valves M3H True Bore (2½" to 4" ASME BPE | DN 65 - 100 DIN)

DIMENSIONS (mm) ASME BPE

SIZE	A1	A2	A3	A3.1	A3.2	B	C	D	E	ØF	ØG	ØH	I	BALL PORT	ISO 5211	WGT. (kg)
2½"	190	203	196,3	95	101,5	160	72,5	169	355	77,5	63,5	60,2	37	60,2	F7	13,3
3"	216	228	222	108	111	180	83,5	180	355	91	76,2	72,9	38	72,9	F7	18,6
4"	254	267	260,5	127	133,5	220	101,5	198	460	119	101,6	97,4	44	97,4	F10	29,6

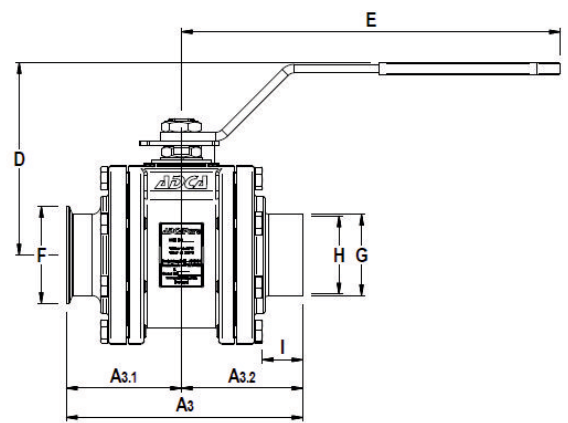
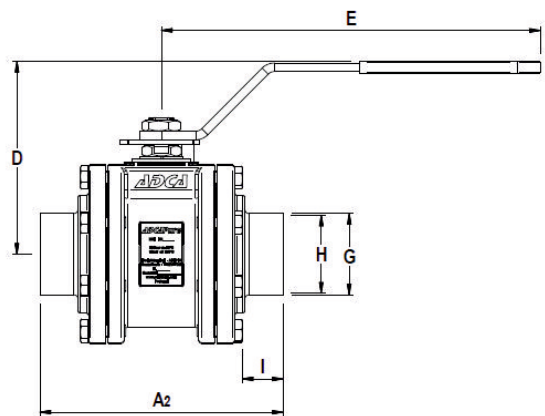
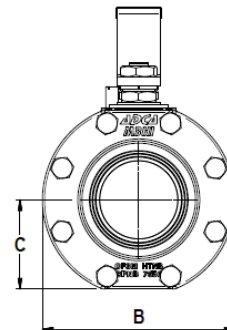
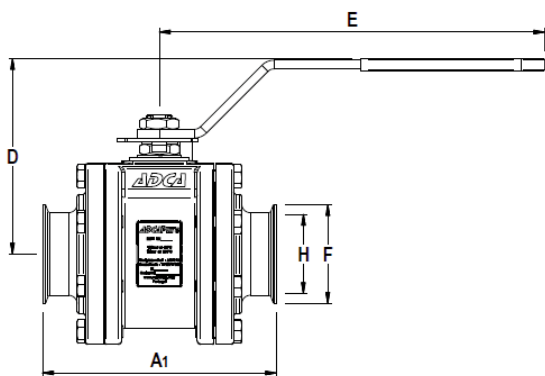

Tube weld easy and quick installation - optional

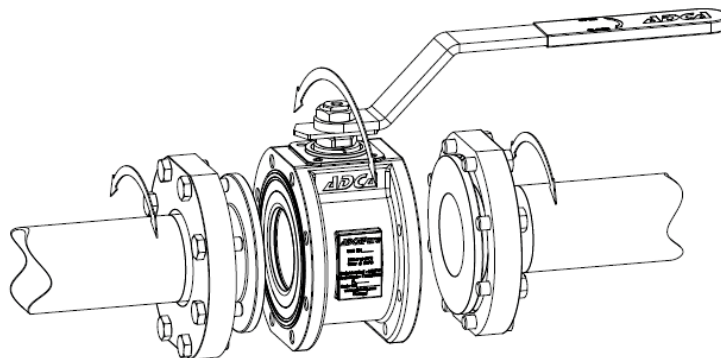

Loose body flanges make it possible to install the valve without aligning of welded end connections. After installation the valve can rotate on 360° for the desired orientation.